

PLAN-ASSEMBLED

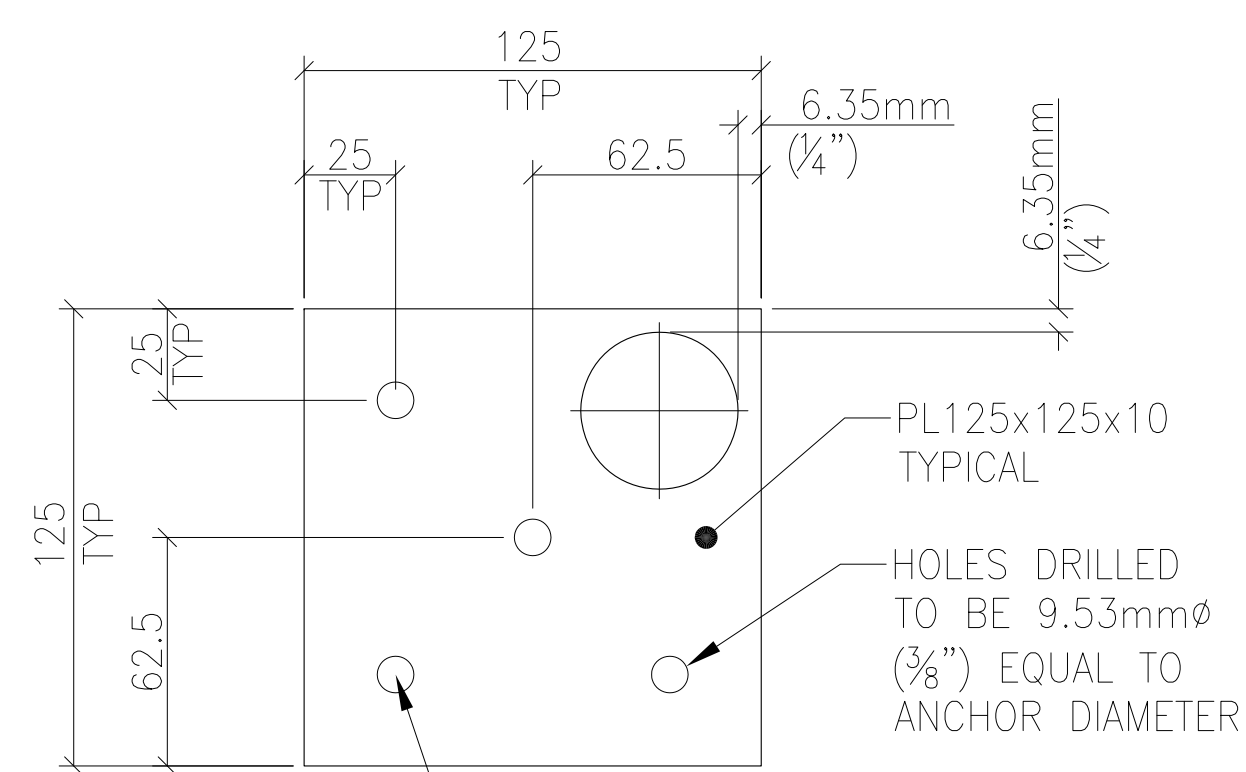

4 - 9.53mm ϕ 125mm LG REDHEAD WEDGE ANCHOR OR EQUIVALENT

1 ANCHOR PLATE

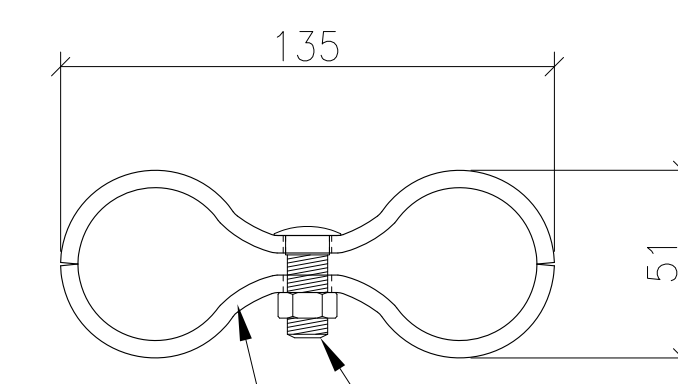

63.5x4.76 CLAMP 12mm ϕ 51mm LG BOLT & NUT

2 SADDLE CLAMP

DETAILS

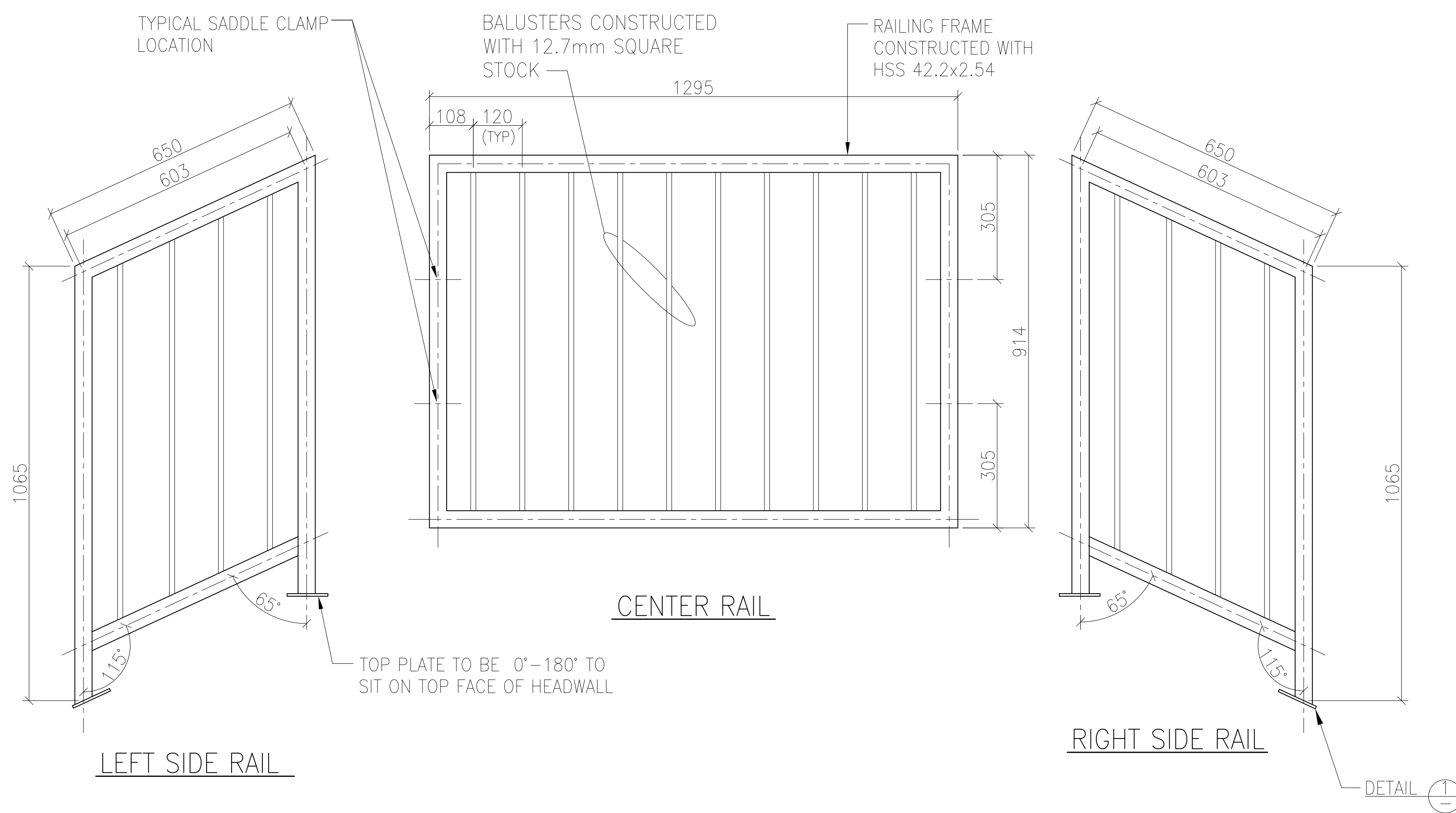

DEVELOPED ELEVATION

CONSTRUCTION NOTES:

1. ALL RAILING STEEL COMPONENTS TO BE GALVANIZED.
2. CUT OR DRILL HOLES IN RAILING FOR GALVANIZING AS REQUIRED.
3. ALL CONNECTIONS TO BE 3mm FILLET WELD.
4. CENTER RAIL SHALL BE ATTACHED TO LEFT AND RIGHT SIDE RAILS WITH SADDLE CLAMPS. (BY CONTRACTOR)

SHAW SUPPLIED ITEMS

16	9.53 ϕ mm (3/8") STEEL WEDGE ANCHORS
4	SADDLE CLAMP SETS c/w BOLT & NUT

REV. NO.	REVISION	DATE
----------	----------	------



PROJECT TITLE:
STD-HWHAND1050

PRODUCT CODE:
HWHAND

DRAWING TITLE:
DRIVEWAY HEADWALL
HANDRAIL FOR:
1050 REGULAR

DATE	MAY 2012	DESIGNED	STAFF
DRAWN	M.CAMERON	CHECKED	STAFF