

SUPER SHAWSPAN WEIGHTS (kgs)

LAY LENGTH = 1200mm

AVAILABLE RISE (mm)	AVAILABLE SPAN (mm)					
	12200	12810	13420	14030	14640	15250
1220	25,500	26,500	27,500	28,000	29,000	29,500
1830	27,000	28,000	29,000	29,500	30,500	31,000
2440	28,500	29,500	30,000	31,000	32,000	32,500
3050	30,000	30,500	31,500	32,500	33,000	34,000

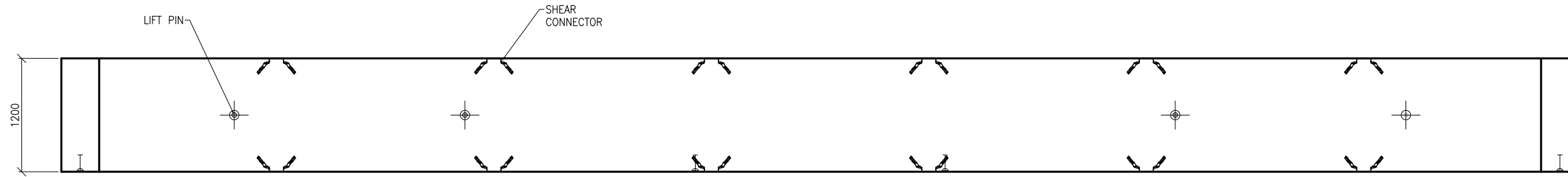

PLAN

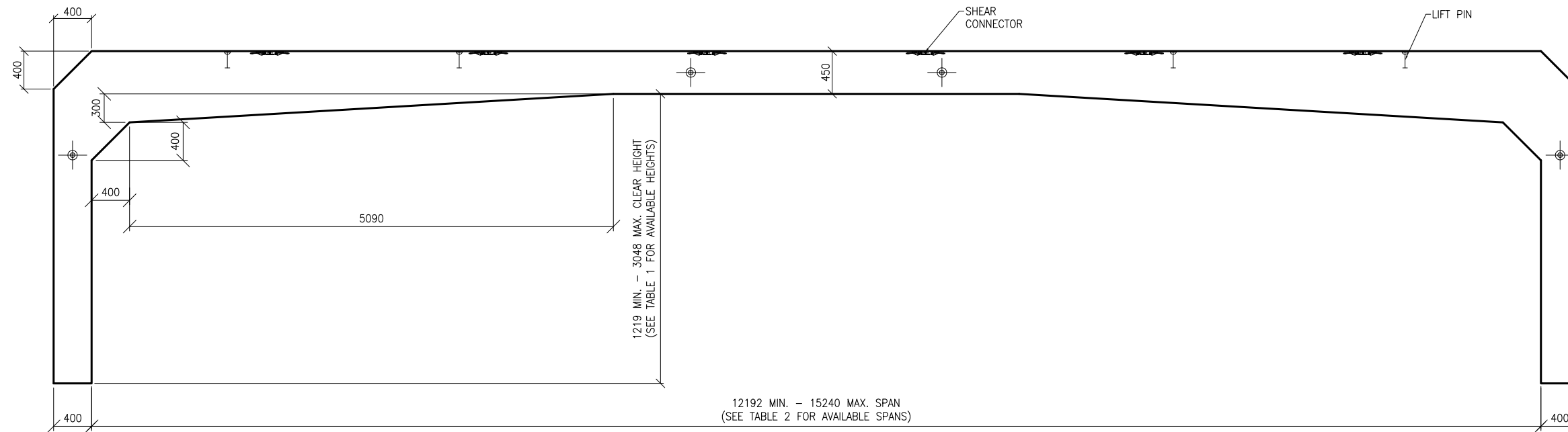

ELEVATION

NOTES

- GENERAL
- FOR HANDLING, STORAGE, TRANSPORTATION AND ERECTION PROCEDURES PLEASE REFER TO "SHAWSPAN INSTALLATION GUIDE" AND "DAYTON/RICHMOND GUIDELINES FOR HANDLING CONCRETE PIPE AND UTILITY PRODUCTS".
 - WEIGHTS: STANDARD UNIT = VARIES
 - TOLERANCE FOR STRUCTURAL ELEMENTS, MATERIALS & CONSTRUCTION CONFORM TO CAN/CSA A23.4 "PRECAST CONCRETE" CLAUSE 10.
 - JOINT MATERIAL TO BE SUPPLIED BY SHAW PIPE. CONTRACTOR IS RESPONSIBLE FOR INSTALLATION OF JOINT MATERIALS.

REV. NO.	REVISION	DATE



DRAWING No. SSS40-50STD

PROJECT TITLE: TYPICAL SUPER SHAWSPAN

DRAWING TITLE: SUPER SHAWSPAN

GEOMETRY			
DATE	DESIGNED	CHECKED	DRAWN
14 MARCH 2013	R.BROOKMAN	R.BROOKMAN	C.MACKINNON